



WAYNE-DALTON, A DIVISION OF THE
OVERHEAD DOOR CORP.

EXTERIOR VIEW

WAYNE-DALTON CONFIDENTIAL PROPRIETARY
NOT TO BE DUPLICATED OR REPRINTED WITHOUT
WRITTEN PERMISSION FROM OVERHEAD DOOR CORP.

WWW.WAYNE-DALTON.COM

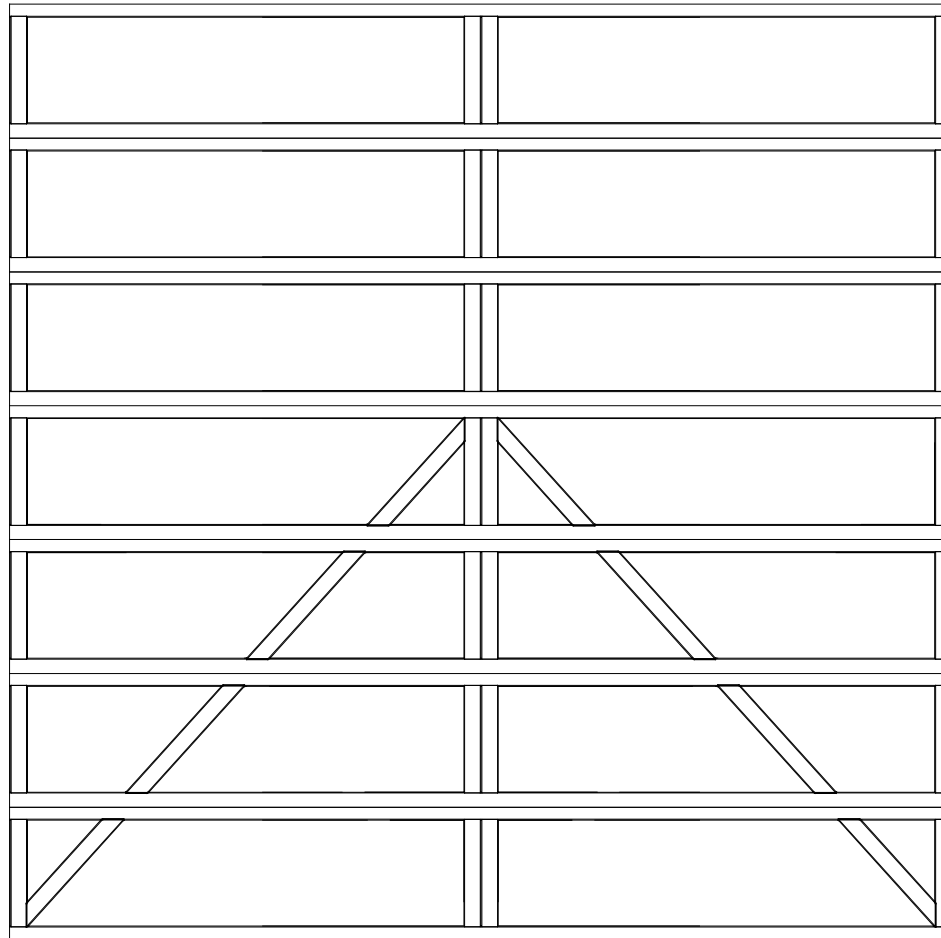

14' X 13'11" 9405 CHARLESTON DESIGN
7 SECTION / 2 PANEL
SOLID TOP SECTION SHOWN
CONSISTS OF (7) 23.8" SECTIONS