

MODEL	STANDARD MAX. VALUES	
	WIDTH	HEIGHT
530	40' 2"	24' 1"

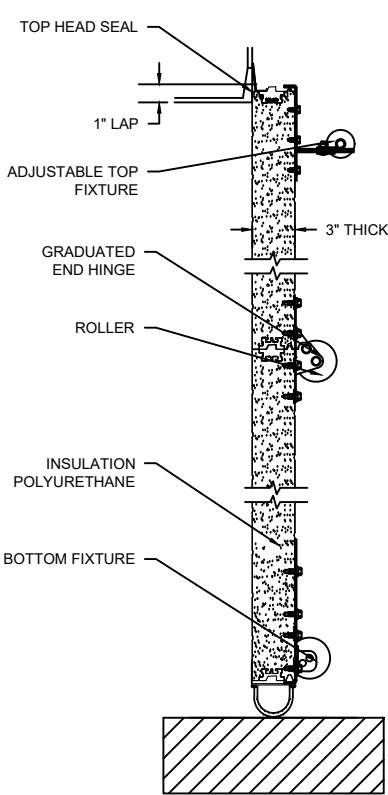

SECTION B-B

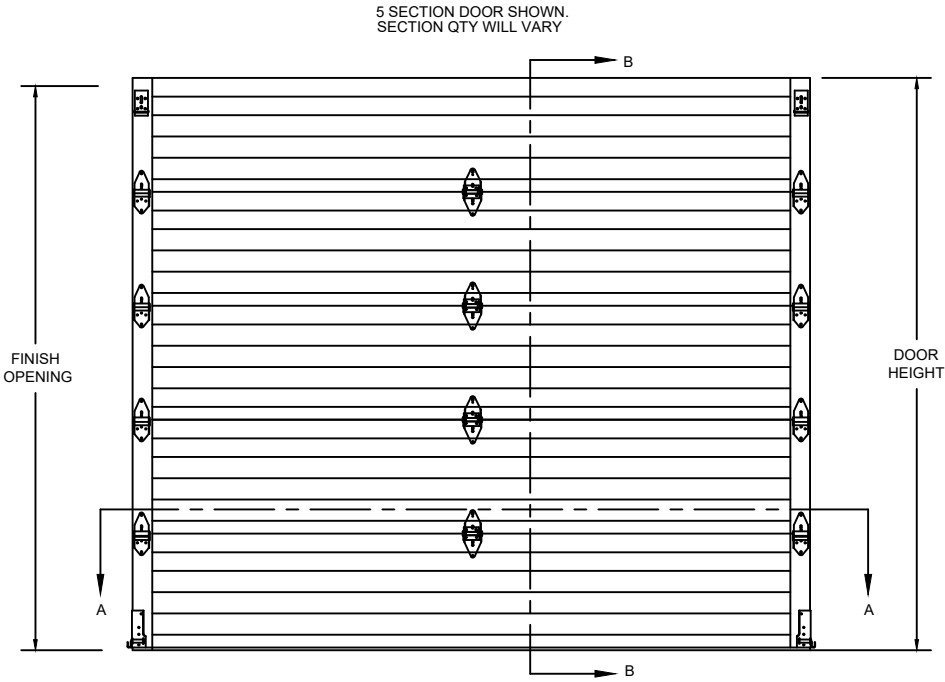

ELEVATION

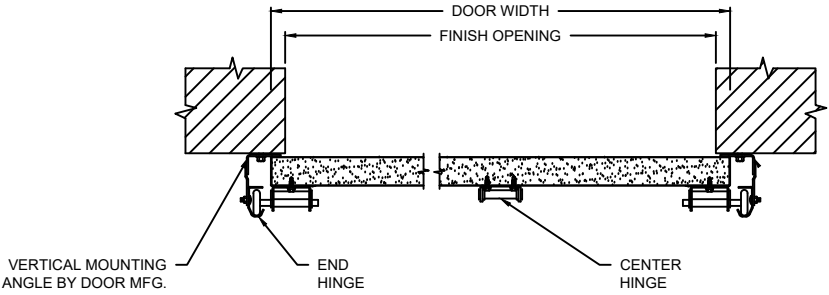

SECTION A-A

OPTIONS	
OPENING WIDTH	
OPENING HEIGHT	
DOOR TRACK SIZE	<input type="checkbox"/> 2" <input type="checkbox"/> 3"
END STILES	<input type="checkbox"/> SINGLE <input type="checkbox"/> DOUBLE
WINDOW OPTIONS	<input type="checkbox"/> NO WINDOW <input type="checkbox"/> ONE - 24" X 6" <input type="checkbox"/> TWO - 24" X 6" <input type="checkbox"/> THREE - 24" X 6" <input type="checkbox"/> ONE - 24" X 12" <input type="checkbox"/> TWO - 24" X 12" <input type="checkbox"/> THREE - 24" X 12"
SEAL OPTIONS	<input type="checkbox"/> JAMB SEAL <input type="checkbox"/> STANDARD BOTTOM SEAL <input type="checkbox"/> TOP SEAL <input type="checkbox"/> ELECTRIC SAFETY EDGE <input type="checkbox"/> PNEUMATIC SAFETY EDGE <input type="checkbox"/> VINYL STOP MOLD

COMPONENT	MATERIAL	OPERATION	NOTES:
SECTIONS	ROLL-FORMED, HOT DIPPED, GALVANIZED	MANUAL	- THE INSULATION WILL HAVE A U-FACTOR OF 0.07 (R-VALUE OF 26.00). U-FACTOR VALUES ARE INDEPENDENTLY TESTED AND VERIFIED PER ANSI/DASMA 105. OVERHEAD DOOR™ BRAND USES A CALCULATED DOOR SECTION R-VALUE FOR OUR INSULATED DOORS. THIS DOOR FEATURES TESTED AIR INFILTRATION AT 25 MPH (40 KMPH) OF .21 CFM/FT² (3.83 M³/HR/M²).
END STILES	14 GA. /16 GA. STEEL		
HARDWARE	GALVANIZED STEEL		
WEATHERSTRIP	PVC INTERIOR, EPDM EXTERIOR		

# THERMOMARK™

530 SECTIONAL STEEL DOORS (INSULATED)

DWG. NO.	DATE:	Wayne Dalton.
SHEET	BY:	