

## K-AL

### ALUMINUM FULL-VIEW



#### WHEN VISIBILITY AND LIGHT TRANSMISSION COUNT MOST

Wayne Dalton's K-AL Aluminum Full-View Doors are ideally suited for a variety of commercial applications ranging from car washes and tire stores to store fronts and other buildings where maximum light and visibility are desired. Available in Clear, Bronze and Black anodized or powder coated colors.

The Model K-AL door is sturdy, virtually maintenance free and weather resistant.

- MAXIMIZES LIGHT AND VISIBILITY
- WIDE RANGE OF GLASS OPTIONS
- STANDARD SIZES UP TO 24' WIDE AND 18' HIGH
- OPTIONAL INSULATED RAILS AND STILES AVAILABLE

## STANDARD FEATURES OVERVIEW

### CONSTRUCTION

<b>MAX WIDTH</b>	24' (7,315 mm)
<b>MAX HEIGHT</b>	18' (5,486 mm)
<b>DOOR ASSEMBLY</b>	Stile and rail assembly of aluminum alloy 6063-T6, 2" thick stiles and rails, joined with self tapping screws
<b>RAILS</b>	Top and bottom rails with 3" wide, lower intermediate rail 1- <sup>3</sup> / <sub>8</sub> ", upper rail 1- <sup>3</sup> / <sub>8</sub> ", minimum wall thickness 0.062"
<b>STILES</b>	End stiles and center stiles are 3" wide, minimum wall thickness 0.062". Double end stiles are optional or as required by weight
<b>SPRINGS</b>	10,000 cycles
<b>LOCK</b>	Interior mounted slide lock
<b>WEATHERSTRIPPING</b>	Flexible bulb-type strip at bottom section
<b>TRACK</b>	Provide track as recommended by manufacturer to suit loading required and clearances available
<b>MANUAL OPERATION</b>	Pull rope or chain hoist
<b>ELECTRIC MOTOR OPERATION</b>	Provide UL listed electric operator, equal to Genie Commercial Operators, size and type as recommended by manufacturer to move door in either direction at not less than <sup>2</sup> / <sub>3</sub> foot or more than 1 foot per second

### WARRANTY

<b>TERMS</b>	Five (5) year limited
--------------	-----------------------

### OPTIONS

- Springs: 25,000, 50,000 or 100,000 cycles
- Lock options: Interior mounted slide lock with interlock switch for automatic operator, keyed lock, keyed lock with interlock switch for automatic operator
- Weather stripping: Jamb and header seals
- Insulated rails and stiles for a R-value\* of up to 4.25
- Powder coat finish: White, Brown, Black, RAL
- Anodized finishes: Clear, Dark Bronze, Black
- Multiple <sup>1</sup>/<sub>8</sub>", <sup>1</sup>/<sub>4</sub>", <sup>1</sup>/<sub>2</sub>" glass options available



Wayne Dalton participates in the DASMA Thermal Performance Verification Program. The program verifies the thermal performance of sectional doors. The lower the U-factor rating, the better the thermal performance.

 Symbol indicates verified U-factor rating in accordance with the DASMA Thermal Performance Verification Program.

**Wayne Dalton's Aluminum Full-View Doors are the preferred choice when visibility and light transmission are just as important as aesthetics.**

### MATERIALS AND CONSTRUCTION

Aluminum Full-View sectional doors are weather-resistant and virtually maintenance free, and are ideal for commercial applications such as service stations, car washes, and auto dealerships. This door is perfectly suited for applications where maximum light and visibility are desired.

### FINISH OPTIONS

#### Anodized



Clear (Standard)



Dark Bronze



Black

#### Powder Coat (optional)

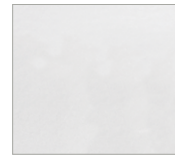

White



Brown



Black

Approximately 200 RAL powder coat finishes also available to complement the exterior colors of a building.



### GLASS OPTIONS



Clear (Standard)



Gray Tinted



Green Tinted



Bronze Tinted



Low E

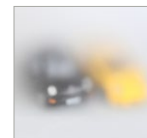

Satin Etched

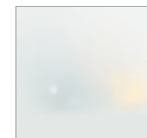

White Laminated

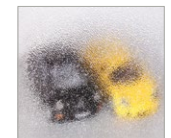

Obscure

# ALUMINUM FULL-VIEW



Light-glass frame

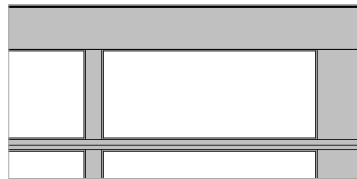

Heavy-glass frame

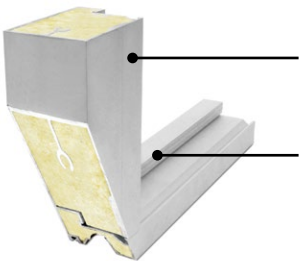

Polyurethane filled stile

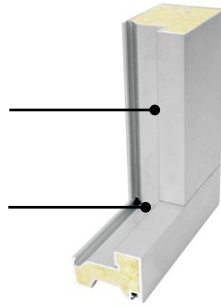

Polyurethane filled rail

**Large glass panels** for maximum light and visibility.

**2" thick** sections with box-type extrusions.

**2-1/4" integral** reinforcing fin on large doors.

**Vinyl weather seal** between sections to minimize air and water infiltration.

**6" bottom rail** with integral reinforcing fin on doors over 16'2" wide. Optional on narrower doors.

**6063T6** aluminum alloy with clear finish.

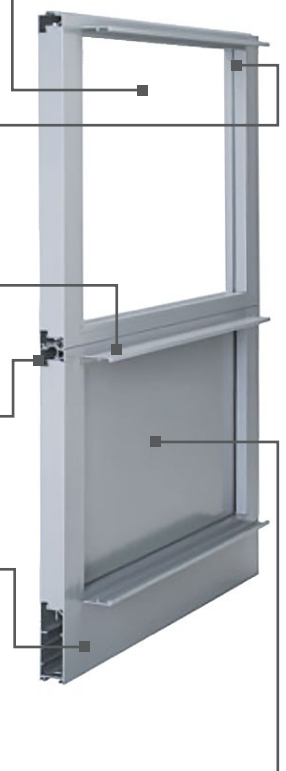

COMPLETE K-AL	U-FACTOR* 	R-VALUE** 10 X 10 DOOR	R-VALUE** 12 X 12 DOOR	R-VALUE** 14 X 14 DOOR
1/2" insulated glass Solar Ban 70XL argon filled (R = 3.125) with polyurethane filled rails and stiles	0.27	4.25	4.18	4.17
1/2" insulated glass Low E (R = 2.38) with polyurethane filled rails and stiles	0.27	3.60	3.52	3.52
1/2" insulated glass (R = 1.75) with polyurethane filled rails and stiles	0.29	3.05	2.96	2.96

\*U-factor is independently tested and verified per ANSI/DASMA 105 using doors with full glazing and specific product sizes.

\*\*Wayne Dalton uses a calculated door section R-value for our insulated doors.

## GENERAL OPERATING CLEARANCES

TYPE	HEADROOM		SIDEROOM		DEPTH INTO ROOM	CENTER LINE OF SPRINGS	
	2" TRACK	3" TRACK	2" TRACK	3" TRACK	2" AND 3" TRACK	2" TRACK	3" TRACK
Standard Lift Manual 12" R	13"-17"	NA	4.5"	5.5"	Opening Height +18"	Opening Height +12"	N/A
Standard Lift Manual 15" R	15"-20"	16"-21"				Opening Height +13"	Opening Height +14"
Standard Lift Motor Oper. 12" R	15"-20"	NA			Opening Height +66"	Opening Height +12"	N/A
Standard Lift Motor Oper. 15" R	15"-20"	18"-24"				Opening Height +13"	Opening Height +14"
High Lift Manual	High Lift +12"		24" One Side		Opening Height -Lift +30"	Opening Height +Lift +6.5"	Opening Height +Lift +7.5"
High Lift Motor Oper.							
Vertical Lift Manual	Door Height +20"		4.5"	5.5"	18"	Double Door Height +13"	
Vertical Lift Motor Oper.			24" One Side				
Low Headroom Manual	6"-15"	6"-15"	6"	9"	Opening Height +20" to -26"	N/A	
Low Headroom Motor Oper.	9"-17"	9"-17"			Opening Height +66"		

### NOTES:

- For low headroom, springs must be rear mount to achieve minimum headroom listed. Front mount torsion headroom depends on drum size, and varies over the range listed. See approval drawing.
- Side-room of 8" required, one side, for doors with chain hoist.
- Headroom depends on drum size, and varies over the range listed. See approval drawing.

## PANEL/SECTION SELECTION GUIDE

DOOR WIDTH	NUMBER OF PANELS	DOOR HEIGHT	NUMBER OF SECTIONS
Up to 9'3" W	2	Up to 8'1"	4
9'4" to 12'3"	3	8'2" to 10'1"	5
12'4" to 16'3"	4	10'2" to 12'1"	6
16'4" to 20'3"	5	12'2" to 14'1"	7
20'4" to 23'7"	6	14'2" to 16'1"	8
23'8" to 24'2"	7	16'2" to 18'1"	9

## TRACK SELECTION GUIDE

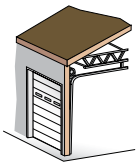

**STANDARD LIFT**



**HIGH LIFT**  
break-away is standard, straight incline is available

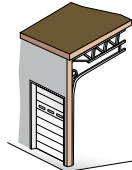

**ROOF PITCH**  
standard or high lift

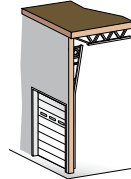

**VERTICAL LIFT**  
break-away is standard, straight incline is available

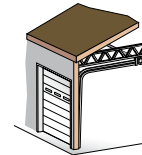

**LOW HEADROOM**  
rear mount torsion

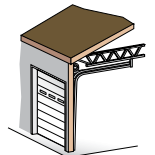

**LOW HEADROOM**  
front mount torsion



**Architect Resource**



Scan the QR code to go to our Architect Resource Center. In this tool, you will quickly find all of the specifications, drawings and documents you need for your project.

**Wayne Dalton**

DISTRIBUTED BY:

2501 S. State Hwy. 121 Bus., Ste 200  
Lewisville, TX 75067

[wayne-dalton.com](http://wayne-dalton.com)

